

XH-EB9530

Title 1

EB9530 Backpack Gas Blower 2-Stroke Commercial Grade 3.4kw 75.6cc Leaf & Snow Removal Equipment

Title 2

3.4Kw Powerful EB9530 Blower Clear Leaves, Snow & Debris Faster Pro-Grade Backpack Design!

Main image + Secondary image









EB9530 Backpack Gas Blower 2-Stroke Commercial Grade 3.4kw 75.6cc Leaf & Snow Removal Equipment



Technical Parameters:

Product Name	Backpack Gasoline Leaf snow dust Blowers
HS Code:	8414599099
Item No.	EB-9530
Engine Model	1E51F
Engine Type	2 Stroke ,air-cooled
Power	3.4KW/7400rpm

Displacement	85CC
Average air volume	1542m³/h
Maximun air volume	1740m³/h
Wind Speed	110 m/s
Fuel Tank Capacity	2.3L
Working time for full tank oil	Approx. 90 mins

3.4Kw Powerful EB9530 Blower Clear Leaves, Snow & Debris Faster
Pro-Grade Backpack Design!

Suitable for multiple scenarios

WIDELY APPLIED IN VARIOUS SCENARIOS, INCLUDING URBAN SNOW REMOVAL,
FOREST FIRE SUPPRESSION, CONSTRUCTION SITE CLEANING, LEAF BLOWING, LAWN CARE AND ROAD MAINTENANCE.



Urban & Road Snow Blowing



Forest Fire Suppression



Road Cleaning / Pathway Clearance



Construction Site Dust & Gravel Removal



Leaf Cleaning & Removal



Lawn Debris & Trash Cleaning

Commodity attribute :

Product Name	Backpack Gasoline Leaf Blower
Place of origin	Zhejiang, China
Item No.	EB-9530
Function	Leaf removal, snow removal, dust removal, fire suppression
Power source	Gasoline or petrol
Motor type	2-Stroke Air-Cooled Gasoline Engine
Color	Red ,orange,customized
N.W./G.W.	12kg/14.5kg
Machine Size	357×511×540mm (excluding the blowing pipe)
Packing Size	58×40.5×58cm
Packing Quantity	1 unit/ctn
Material	ABS + Aluminum Alloy



- **Lightweight Backpack Design:** Only 10.2kg net weight, ergonomic harness ensures long-hour operation without fatigue, ideal for extended yard work and commercial use.
- **Powerful 2-Stroke Gas Engine:** Delivers high-velocity airflow to efficiently clear leaves, snow, debris, and create firebreaks for wildfire prevention.
- **Multi-Scene Versatility:** Perfect for residential yard cleanup, driveway snow removal, construction dust clearing, and professional landscaping tasks.

Powerful wind, cleans in one blow.

Upgraded high-power blower,
large air volume, high efficiency



- **Strong Wind Power:** High-velocity airflow with the capacity to blow 10-12 bricks, delivering exceptional force for heavy-duty leaf, snow, and debris removal tasks.
- **Stable Performance:** Reliable 2-stroke gas engine ensures consistent power output, supporting long-hour operation and minimizing downtime for both residential and commercial use.
- **Backpack Ergonomic Design:** Lightweight structure with a comfortable harness, reducing operator fatigue during extended work while maintaining excellent maneuverability.

Thickened and Widened Straps



- **Thickened & Widened Straps:** Ergonomically widened and thickened shoulder straps distribute weight evenly, enhancing comfort during long-hour operation.
- **Comfort-Focused Back Padding:** Padded back panel with shock-absorbing design reduces pressure and improves wearer comfort.
- **Vibration Reduction Structure:** Built-in vibration-dampening components minimize engine vibration, reducing operator fatigue and improving stability.

Strong Stable

CONSTANT SPEED CRUISE HANDLE



- **Constant Speed Cruise Handle:** Locks in airflow speed for hands-free operation, reducing hand fatigue during extended cleaning tasks.
- **Stepless Shift Control:** Enables precise adjustment of wind speed, allowing flexible handling of light leaves and heavy debris.
- **Strong Stable Grip Design:** Ergonomic non-slip handle with secure switch adjustment, ensuring stable control and comfortable operation.

Dual-layer Filtration System

Automotive-grade filter • Dual protection
Efficient & safer filtering



- **Car Grade Filter Element:** Premium automotive-grade filtration system ensures superior engine protection and extended equipment lifespan.
- **Thickened Sponge Layer:** Dual-layer design with thickened sponge effectively blocks large debris, enhancing filtration durability.
- **Fine Particle Filtration:** High-density pleated filter captures tiny dust and particles, maintaining consistent airflow and stable engine performance.



- **Light Flame Retardant Material:** Lightweight, fire-resistant construction ensures safe operation and enhanced durability in various working environments.
- **Thick & Bigger Air Tubes:** Oversized, robust air tubes maximize airflow delivery, supporting large air volume for efficient leaf, snow, and debris removal.
- **180° Adjustable Air Nozzle:** Flexible up-and-down adjustment design allows precise directional control of airflow, adapting to different cleaning angles and task scenarios.



Fully Enclosed Oil Pipe Design: Fully enclosed structure effectively protects the oil pipe from wear, collision, and external damage, ensuring stable fuel delivery and extending the service life of the EB9530 blower



- **Easy Starter System:** Effortless pull-start design enables quick, one-hand engine ignition, reducing startup effort and improving operational efficiency.
- **EB9530 Model Design:** Robust 2-stroke engine structure with durable orange housing, built for long-lasting heavy-duty performance in landscaping and snow removal tasks.
- **Large Capacity Fuel Tank:** Integrated fuel tank design supports extended continuous operation, minimizing refueling frequency for uninterrupted work.



01

CHOCKE LEVER

Pull it down,
before starting the machine

Pull it up,
after starting the machine

02

BARE OIL BUBBLE

Update oil bubble ,
Safer and handier to use



- **Choke Lever Control:** Simple pull-down/pull-up operation for easy engine startup and post-start adjustment, ensuring reliable ignition in various conditions.
- **Bare Oil Bubble Design:** Updated exposed oil bubble enables intuitive fuel priming, delivering safer, more convenient operation and smoother engine starts.

Component Breakdown

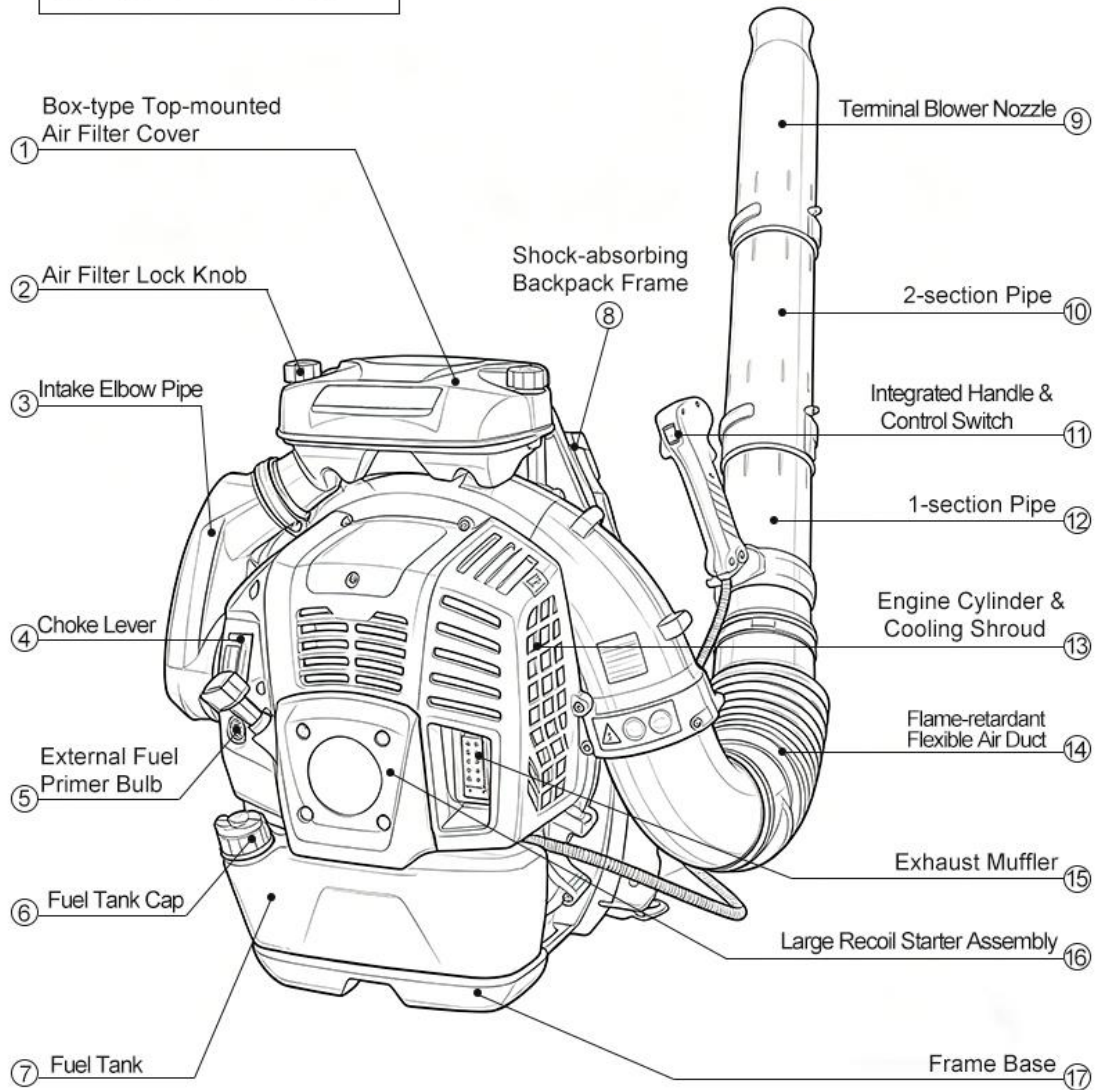

PARTS LOCATION

- 1.Box-type Top-mounted Air Filter Cover
- 2.Air Filter Lock Knob
- 3.Intake Elbow Pipe
- 4.Choke Lever
- 5.External Fuel Primer Bulb
- 6.Fuel Tank Cap
- 7.Fuel Tank
- 8.Shock-absorbing Backpack Frame
- 9.Terminal Blower Nozzle
- 10.2-section Pipe
- 11.Integrated Handle & Control Switch

- 12.1-section Pipe
- 13.Engine Cylinder & Cooling Shroud
- 14.Flame-retardant Flexible Air Duct
- 15.Exhaust Muffler
- 16.Large Recoil Starter Assembly
- 17.Frame Base

Backpack Leaf Blower Operation Guide

- **Pre-Use Preparation:** Check fuel level, air filter and backpack straps. Ensure the machine is placed on a flat, stable surface.
- **Fuel & Engine Start:** Fill with recommended gasoline (no ethanol blend exceeding 10%). Set the choke to "START", pull the starter cord firmly until the engine fires, then switch to "RUN" mode
- **Backpack Mounting:** Secure the backpack harness to your shoulders and waist, adjust for balanced weight distribution to reduce fatigue during long use.
- **Blower Operation:** Grip the handle firmly, squeeze the throttle trigger gradually to increase airflow. Direct the nozzle toward leaves/debris at a 30–45° angle for efficient clearing
- **Speed & Flow Control:** Use the variable throttle to adjust airflow: lower speed for delicate areas, higher speed for heavy leaf piles or stubborn debris
- **Post-Use Shut Down:** Release the throttle trigger, let the engine idle for 1–2 minutes to cool down, then flip the stop switch to "OFF". Wait for all moving parts to stop before setting down.
- **Cleaning & Storage:** Empty leftover fuel (if storing long-term), clean the air filter and nozzle, and store the blower in a dry, dust-free area away from children.



Xinghu Power Machinery Co., Ltd.:

A professional manufacturer of garden machinery with strong production capacity, dedicated to delivering high-quality lawn mowers and power tools to global markets.

Contact Us:

Phone / WeChat / WhatsApp: +86 15268682136

Email: alice@cnxinghu.com

Website: <http://www.cnxinghu.com>

OUR CERTIFICATE

Welcome to our website

WHY CHOOSE US

Welcome to our website

FACTORY
Our company has its own factory, which covers a wide area and has strong production capacity and convenient transportation

PRODUCT QUALITY
Our products have passed the international multi-quality inspection standards

OUR TEAM
Our company has professional production technicians and pre-sales customer service staff

TECHNOLOGY
We use advanced technology and production processes at home and abroad

Fully Certified & Trusted Xinghu Gas Lawn Mowers:
 Backed by ISO, EPA, CE, EUR05 and other global certifications, with strong factory capacity, strict quality control, professional team and advanced technology for reliable garden machinery supply.



Reliable Manufacturing & Supply Chain for Xinghu Gas Lawn Mowers:
From strict factory testing, precision diemaking, full spare parts support to efficient global dispatch, we deliver high-quality

Testing Laboratory

Professional testing laboratory with complete equipment, strict quality control to ensure stable and reliable products.

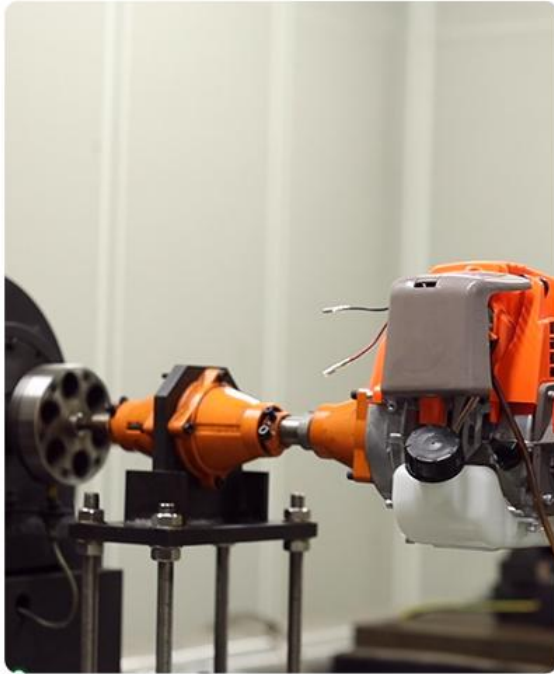

Professional Testing Laboratory:

Equipped with complete testing facilities and strict quality control to guarantee stable, reliable performance for Xinghu gas lawn mowers and garden machinery.



In the Canton Fair



Xinghu at the Canton Fair:

Showcasing premium gas lawn mowers and garden machinery to global buyers, building trusted partnerships for worldwide distribution.

50 FAQ - EB9530 Backpack Gas Blower

Product Basics

1. **What is the EB9530 blower used for?** Ideal for leaf removal, snow clearing, gravel blowing, fire prevention, and construction dust cleanup.

2. **What engine type does it use?**2-stroke gasoline engine, 85cc displacement, 3.2Kw power output.
3. **What is the net weight of the EB9530?**10.2kg, designed for easy backpack carrying.
4. **What is the fuel tank capacity?**2.4L, supporting up to 2.5 hours of continuous operation.
5. **What is the fuel-oil mixing ratio?**25:1 (gasoline to 2-stroke engine oil).
6. **What is the maximum wind speed?**110m/s, with a max air volume of 1740m³/h.
7. **Is it suitable for commercial use?**Yes, heavy-duty build for professional landscaping and municipal tasks.
8. **What color is the EB9530?**Orange and gray, with high visibility for outdoor work.
9. **Does it come with a warranty?**Standard 1-year manufacturer warranty for engine and core components.
10. **Where is the EB9530 manufactured?**Made in China, with OEM/ODM services available for bulk orders.

✦✦ Key Features

1. **Is the backpack strap comfortable?**Yes, thickened widened straps with shock absorption reduce fatigue during long use.
2. **Does it have a cruise control handle?**Yes, constant speed cruise handle for hands-free operation.
3. **Is the air tube adjustable?**180° up/down adjustable nozzle for precise airflow direction.
4. **What material is the air tube made of?**Flame retardant, thickened plastic for durability and safety.
5. **Is the filter easy to clean?**Car-grade filter element with thickened sponge, washable and reusable.
6. **Is the starter easy to use?**Easy recoil starter, one-hand pull operation for quick ignition.
7. **Does it have vibration reduction?**Back padding and strap design minimize engine vibration.
8. **Is the oil pipe protected?**Fully enclosed oil pipe design prevents damage and leaks.
9. **Is the choke lever easy to operate?**Simple pull-down/pull-up for cold start and warm engine adjustment.

10. **What is the bare oil bubble for?** Exposed oil bubble for intuitive fuel priming, ensuring smoother starts.

Operation & Maintenance

1. **How to start the EB9530?** Pull choke lever down → prime oil bubble → pull starter cord → push choke lever up after startup.
2. **How to adjust the wind speed?** Use the stepless shift control on the handle for precise speed changes.
3. **How to refuel the machine?** Turn off engine, cool down, mix fuel at 25:1 ratio, fill tank, and secure cap tightly.
4. **How often to clean the air filter?** Clean every 25 hours of use; replace every 100 hours or when heavily clogged.
5. **How to maintain the engine?** Change oil regularly, check spark plug, and clean cooling fins after each use.
6. **Can it run on ethanol gasoline?** Recommended to use unleaded gasoline ($\leq 10\%$ ethanol) for best performance.
7. **What to do if it won't start?** Check fuel level, spark plug connection, air filter clog, and choke lever position.
8. **How to store the blower long-term?** Drain fuel, clean filter, and store in a dry, cool place away from moisture.
9. **Is it easy to assemble?** Pre-assembled, only need to attach the nozzle and adjust straps before use.
10. **How to replace the air filter?** Open engine cover, remove old filter, install new one, and secure the cover.

Application Scenarios

1. **Can it clear heavy snow?** Yes, high wind speed effectively blows snow from driveways and roads.
2. **Can it be used for fire prevention?** Ideal for creating firebreaks by clearing dry leaves and debris in forest areas.
3. **Can it blow gravel and sand?** Strong airflow handles gravel and sand for construction site cleanup.
4. **Is it suitable for residential yard use?** Yes, lightweight design works well for backyard leaf and debris removal.
5. **Can it be used in dusty environments?** High-quality air filter protects engine from dust, suitable for construction sites.
6. **Is it noisy during operation?** Standard noise level for gas blowers; recommended to use ear protection.

7. **Can it blow wet leaves?**Yes, high-velocity airflow handles wet and heavy leaves effectively.
8. **Is it suitable for roadside cleanup?**Yes, portable design works well for municipal roadside leaf and trash removal.
9. **Can it be used in hot weather?**Efficient cooling system allows continuous operation in high temperatures.
10. **Is it safe to use around flammable materials?**Flame retardant parts and enclosed design reduce fire risk; avoid direct contact with fuels.

Order & Shipping

1. **What is the MOQ for bulk orders?**MOQ is 1 unit for sample orders, 50 units for bulk production.
2. **Do you offer OEM/ODM services?**Yes, custom logo, color, and packaging are available.
3. **What is the lead time for bulk orders?**7-15 days for sample orders, 20-30 days for mass production.
4. **What shipping methods are available?**Sea, air, and express delivery (DHL, FedEx, UPS) for global orders.
5. **Is the product CE certified?**Yes, meets CE safety standards for European and global markets.
6. **Do you provide after-sales service?**Technical support and spare parts supply for all products.
7. **Can I get a free sample?**Sample available at cost price, with shipping fee paid by buyer.
8. **What is the packaging size?**Standard export carton: 58x45x60cm, suitable for container shipping.
9. **Is the product insured during shipping?**Yes, cargo insurance is optional for bulk orders to protect against damage.
10. **Do you offer dropshipping?**Yes, support dropshipping for e-commerce platforms like Amazon and Shopify.